

TOTAL AREA -  
114.92 M<sup>2</sup>  
(1236.53 Sqft)

SLAB BOTTOM - 299CM.  
BEAM BOTTOM - 267CM.

PROPOSED DESIGN FOR M/S : UIIC @ KADAVANTHRA

ILLUSIONS

DRAWING TITLE : INTERIOR LAYOUT

ARCHITECTURAL ENGINEERS INTERIOR DESIGNERS  
67 GIRINAGAR, KOCHI - 20  
TEL: +91-484-2317701, E-mail ;manoj.illusions@yahoo.in

SHEET NO	DRAWING NO	DATE	DRAWN	SCALE	CKD	NO	REVISION DATE	
01	01	07 - 01 - 2020	AKHIL RAVI	1:100	MKM	01	09 - 01 - 2020	AKHIL
						02	15 - 01 - 2020	AKHIL
						03	16 - 01 - 2020	AKHIL

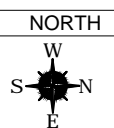

> ALL DIMENSIONS TO BE CHECKED AT SITE.  
> NO DIMENSION TO BE SCALED OFF FROM DRAWINGS ONLY WRITTEN DIMENSION TO BE FOLLOWED.  
> IN THE EVENT OF ANY DISCREPANCIES OF DIFFERENCE STRUCTURAL DRAWINGS OTHER ENGINEERING DRAWING OR SITE CONDITION OR OTHER WISE IMMEDIATE REFERENCE IS TOBE MADE TO THE CONSULTANT FOR CLARIFICATION PRIOR TO EXECUTION OF WORK AT SITE.

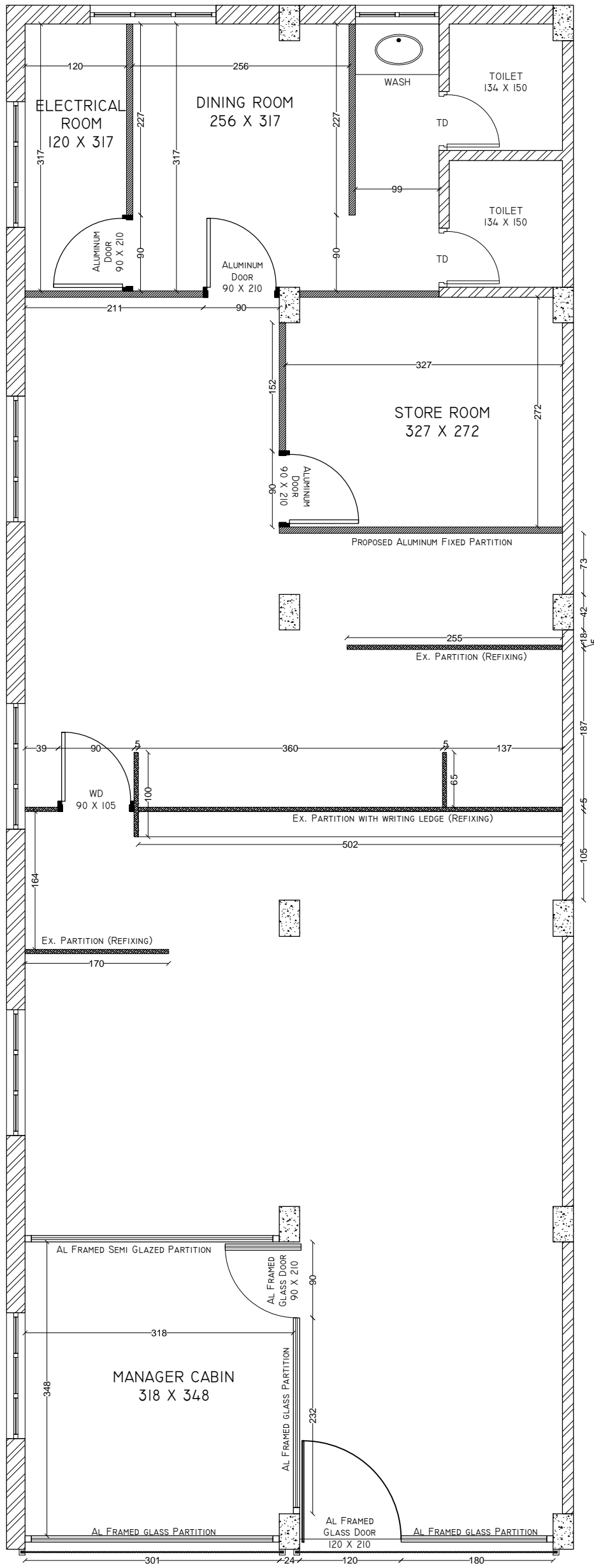

TOTAL AREA -  
114.92 M<sup>2</sup>  
(1236.53 SQFT)

SLAB BOTTOM - 299CM.  
BEAM BOTTOM - 267CM.

NOTE : EX. PARTITIONS USING  
FOR NEW BRANCH

PROPOSED DESIGN FOR M/S : UIIC @ KADAVANTHRA

ILLUSIONS

DRAWING TITLE : PARTITION LAYOUT

ARCHITECTURAL ENGINEERS INTERIOR DESIGNERS  
67 GIRINAGAR, KOCHI - 20  
TEL: +91-484-2317701, E-mail ;manoj.illusions@yahoo.in

SHEET NO	DRAWING NO	DATE	DRAWN	SCALE	CKD	NO	REVISION DATE
01	02	23 - 01 - 2020	AKHIL RAVI	1:100	MKM		

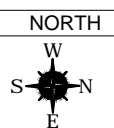

> ALL DIMENSIONS TO BE CHECKED AT SITE.  
> NO DIMENSION TO BE SCALED OFF FROM DRAWINGS ONLY WRITTEN DIMENSION TO BE FOLLOWED.  
> IN THE EVENT OF ANY DISCREPANCIES OF DIFFERENCE STRUCTURAL DRAWINGS OTHER ENGINEERING DRAWING OR SITE CONDITION OR OTHER WISE IMMEDIATE REFERENCE IS TOBE MADE TO THE CONSULTANT FOR CLARIFICATION PRIOR TO EXECUTION OF WORK AT SITE.

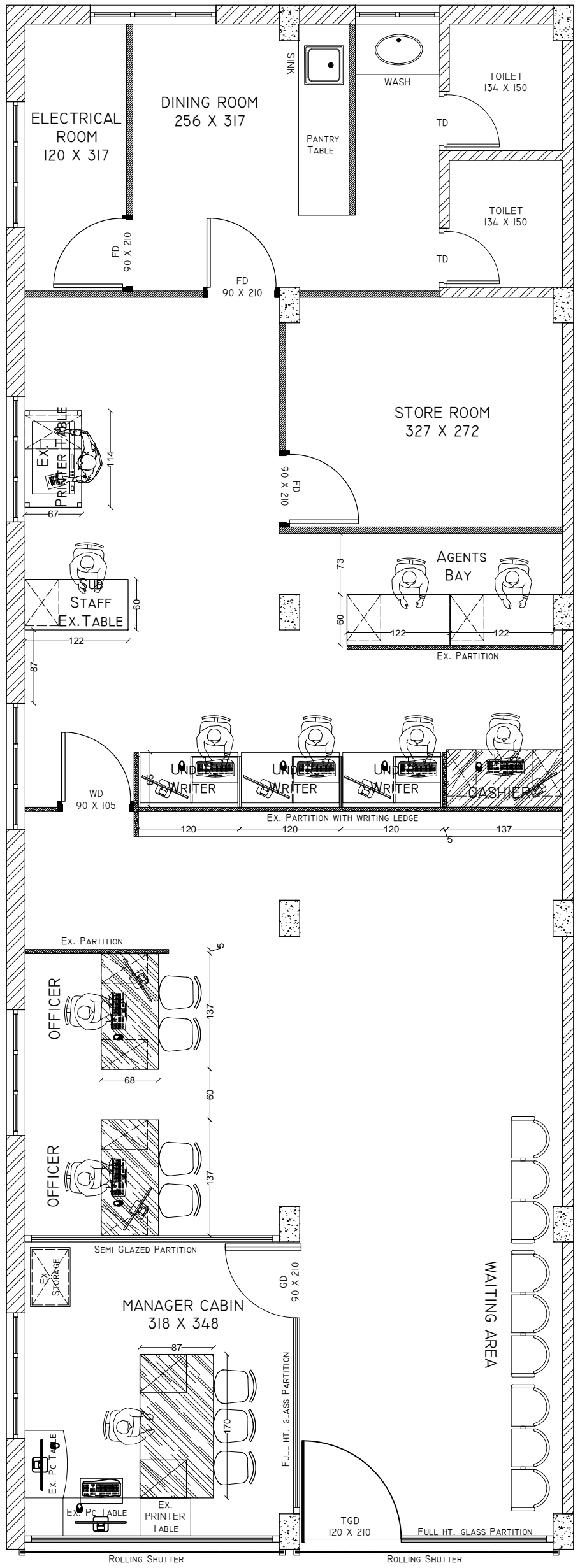

TOTAL AREA -  
114.92 M<sup>2</sup>  
(1236.53 SqFT)

SLAB BOTTOM - 299CM.  
BEAM BOTTOM - 267CM.

PROPOSED DESIGN FOR M/S : UIIC @ KADAVANTHRA

ILLUSIONS

DRAWING TITLE : DIMENSIONS LAYOUT

ARCHITECTURAL ENGINEERS INTERIOR DESIGNERS  
67 GIRINAGAR, KOCHI - 20  
TEL: +91-484-2317701, E-mail ;manoj.illusions@yahoo.in

SHEET NO	DRAWING NO	DATE	DRAWN	SCALE	CKD	NO	REVISION DATE
01	03	23 - 01 - 2020	AKHIL RAVI	1:100	MKM		

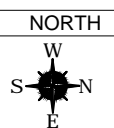

> ALL DIMENSIONS TO BE CHECKED AT SITE.  
> NO DIMENSION TO BE SCALED OFF FROM DRAWINGS ONLY WRITTEN DIMENSION TO BE FOLLOWED.  
> IN THE EVENT OF ANY DISCREPANCIES OF DIFFERENCE STRUCTURAL DRAWINGS OTHER ENGINEERING DRAWING OR SITE CONDITION OR OTHER WISE IMMEDIATE REFERENCE IS TOBE MADE TO THE CONSULTANT FOR CLARIFICATION PRIOR TO EXECUTION OF WORK AT SITE.

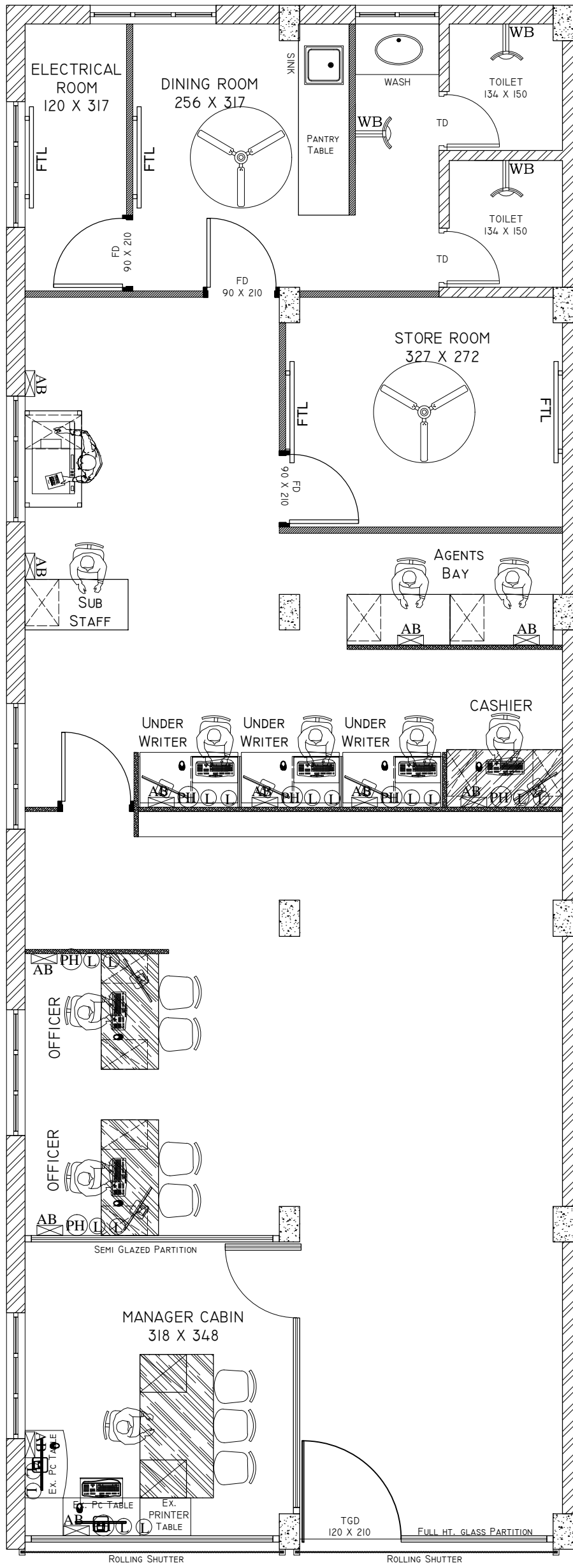

TOTAL AREA -  
114.92 M<sup>2</sup>  
(1236.53 Sqft)

SLAB BOTTOM - 299CM.  
BEAM BOTTOM - 267CM.

PROPOSED DESIGN FOR M/S : UIIC @ KADAVANTHRA

ILLUSIONS

DRAWING TITLE : ELECTRICAL LAYOUT

ARCHITECTURAL ENGINEERS INTERIOR DESIGNERS  
67 GIRINAGAR, KOCHI - 20  
TEL: +91-484-2317701, E-mail ;manoj.illusions@yahoo.in

SHEET NO	DRAWING NO	DATE	DRAWN	SCALE	CKD	NO	REVISION DATE
01	04	23 - 01 - 2020	AKHIL RAVI	1:100	MKM		

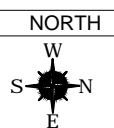

> ALL DIMENSIONS TO BE CHECKED AT SITE.  
> NO DIMENSION TO BE SCALED OFF FROM DRAWINGS ONLY WRITTEN DIMENSION TO BE FOLLOWED.  
> IN THE EVENT OF ANY DISCREPANCIES OF DIFFERENCE STRUCTURAL DRAWINGS OTHER ENGINEERING DRAWING OR SITE CONDITION OR OTHER WISE IMMEDIATE REFERENCE IS TOBE MADE TO THE CONSULTANT FOR CLARIFICATION PRIOR TO EXECUTION OF WORK AT SITE.

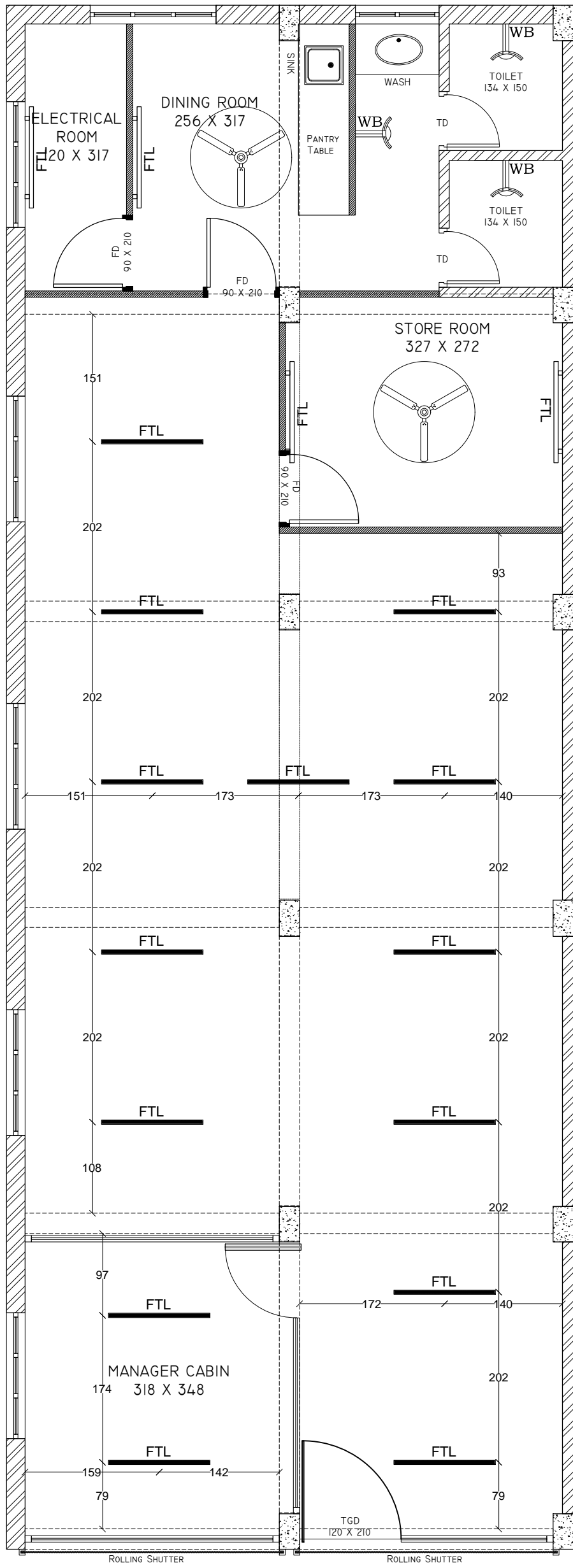

TOTAL AREA -  
114.92 M<sup>2</sup>  
(1236.53 SQFT)

SLAB BOTTOM - 299CM.  
BEAM BOTTOM - 267CM.

PROPOSED DESIGN FOR M/S : UIIC @ KADAVANTHRA

ILLUSIONS

DRAWING TITLE : CEILING ELECTRICAL LAYOUT

ARCHITECTURAL ENGINEERS INTERIOR DESIGNERS  
67 GIRINAGAR, KOCHI - 20  
TEL: +91-484-2317701, E-mail ;manoj.illusions@yahoo.in

SHEET NO	DRAWING NO	DATE	DRAWN	SCALE	CKD	NO	REVISION DATE
01	05	23 - 01 - 2020	AKHIL RAVI	1:100	MKM		

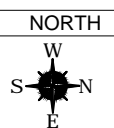

> ALL DIMENSIONS TO BE CHECKED AT SITE.  
> NO DIMENSION TO BE SCALED OFF FROM DRAWINGS ONLY WRITTEN DIMENSION TO BE FOLLOWED.  
> IN THE EVENT OF ANY DISCREPANCIES OF DIFFERENCE STRUCTURAL DRAWINGS OTHER ENGINEERING DRAWING OR SITE CONDITION OR OTHER WISE IMMEDIATE REFERENCE IS TOBE MADE TO THE CONSULTANT FOR CLARIFICATION PRIOR TO EXECUTION OF WORK AT SITE.